

DIFFERENTIAL PRESSURE TRANSMITTER



DP1000 차압트랜스미터는 공조덕트 및 실간 차압을 정밀 측정하며, 또한 Airflow Measuring Station에서 유발된 차압신호와 연결하여 풍량 측정용으로 사용합니다. 측정된 압력값은 Analog 신호로 출력되며, Variable Capacitance Sensor를 사용하여 정확한 측정과 신뢰성 있는 신호를 출력합니다.

This Differential Pressure Transmitters utilizes a quality ceramic capacitive sensor and reliable electronics to provide long term stability and good performance.

This is suitable for use in measuring duct or room differential pressure, and airflow from pitot tubes in HVAC applications.

● Features

- Cost effective
- Compact & rugged enclosure
- Low differential pressure measurement
- Stainless steel diaphragm
- Accepts AC/DC power supply voltages

● Applications

- Space differential pressure
- Duct air velocity
- Duct static pressure
- Lab. and fume hood control
- Leak detection

▶ MODEL : DP1000

DIFFERENTIAL PRESSURE TRANSMITTER

Specifications

| | | | |
|-----------------|---|--------------------|----------------------------|
| Supply voltage | 24VAC/DC | Operating temp | 0 - 50°C |
| Accuracy | ± 1% of F.S. | Operating humidity | 0 - 95%RH |
| Response time | 15mSec - 63% full scale step | Max pressure | Span < 2" H ₂ O |
| Position effect | 1% Null shift from vertical to horizontal | Connections | |
| Output | 4-20mADC | Pressure | Push-in-6-1/8" |
| | 1-5VDC, 2-10VDC | Electrical | 22mm ∅ Cable entries |
| | | Warranty | 2 years |

Ordering information

| Output | Diff. Pressure Range | |
|--|----------------------|----------------------|
| DP1000 - <input type="text"/> - <input type="text"/> <input type="text"/> | | |
| 1. 4-20mA | 01. 0 ~ 0.1" | 11. -0.05" ~ 0.05" |
| 2. 2-10VDC | 25. 0 ~ 0.25" | 12. -0.125" ~ 0.125" |
| 3. 1-5VDC | 50. 0 ~ 0.50" | 13. -0.25" ~ 0.25" |
| | 75. 0 ~ 0.75" | 14. -0.50" ~ 0.50" |
| | 10. 0 ~ 1.00" | 00. Custom Range |

Dimensions

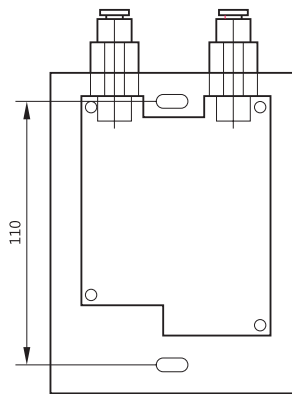

Inside Mounting Hole

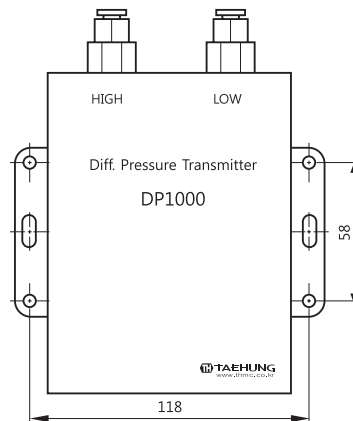

Outside Mounting Hole with Braket

Wiring

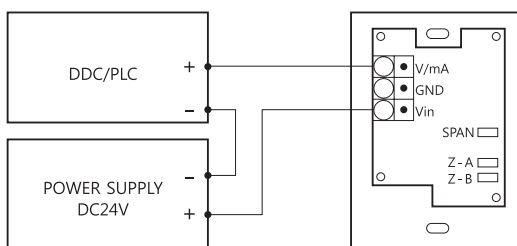

2-wire (4-20mA)

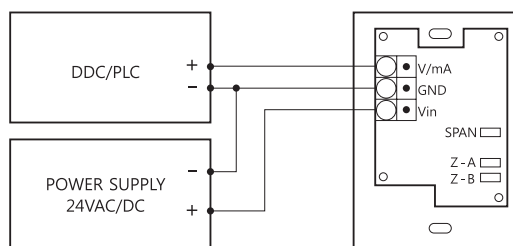

3-wire (4-20mA or 1-5V, 2-10V)